

# Incandescent Square Lights

## KP/KT/KR-337



### ■ Features

- Lamps and lenses can be easily replaced from the front surface.
- Full voltage, transformer, and resistor types are available.
- Built-in transformers and resistors can be easily replaced after being mounted on the panel.

### ■ Model Designation

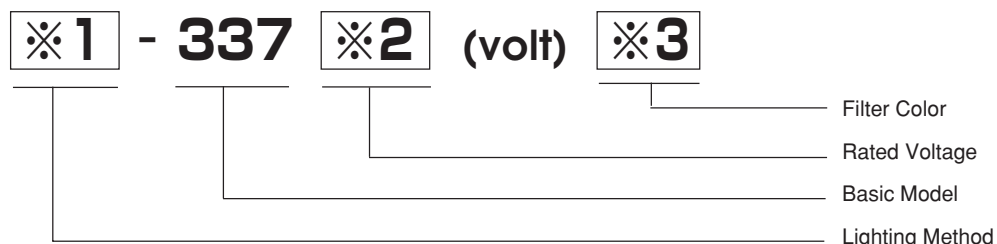

Note: The bezel color is black.

※1	※2	※3
Code	Lighting Method	Rated Voltage
KP	Full Voltage	18V, 24V, 28V, 48V
KT	Transformer	100V, 110V, 200V, 220V
KR	Resistor	100V, 110V

Code	Filter Color
W	Milky white
R	Red
G	Green
O	Orange



WARNING

- Because resistors become very hot, there is the possibility that wires or other flammable objects may catch on fire. Therefore, wires and flammable objects must be placed at least 50mm away from the resistor.
- KR-337 may be very hot when lit, and immediately after turning off. To avoid being burned, do not touch KR-337 under these circumstances.

## ■ Specifications

Model Item	KP-337	KT-337	KR-337
Rated Voltage	48V AC/DC, or less	100V, 110V, 200V, 220V AC	100V, 110V AC/DC
Lamp Voltage	18V, 24V, 28V, 48V	18V	
Applicable bulbs	T-14, 34L, 2W or less, E-12 base	T-14, 34L, 18V, 2W, E-12 base	

Model Item	KP-337	KT-337	KR-337
Insulation Resistance	100MΩ or more between live parts and ground measured by 500V DC megohmmeter		
Withstand Voltage	2000V AC for 1 minute between live parts and ground		
Heat Resistance	For 2 hours at -25 ±3°C and 2 hours at 55 ±3°C		
Humidity Resistance	For 96 hours at 40 ±2°C and 95% RH		
Vibration Resistance	3-dimensional vibration for 1 hour with a sweep time of 1 minute (amplitude: 0.4mm, frequency: 50Hz, and acceleration: 2G)		
Shock Resistance	3-dimensional shock of 500m/s <sup>2</sup> to 6 surfaces, 5 times		
Operating Environment	Temperature: -10 ~ 40°C/Humidity: 45 ~ 85% RH (No freezing or condensation)		
Lighting Color	Milky white, red, green, orange		
Panel Thickness	1~10mm		
Wiring	M3.5×8 screws (torque:1.0 ~ 1.3N·m)	M3×6 screws (torque: 0.6 ~ 0.9N·m)	
Weight	42g	114g	88g

## ■ Materials

Lens	Polycarbonate resin	(transparent)	UL94HB
Legend Plate	Acrylic board	(milky white)	1.0mm thick
Filter	Acrylic board	(transparent, red, green, orange, yellow)	1.0mm thick
Case	Polycarbonate	(black)	UL94HB
Terminal screws	Carbon steel	(zinc plated with chrome treatment)	M3.5×8 or M3×6

## ■ Dimensions

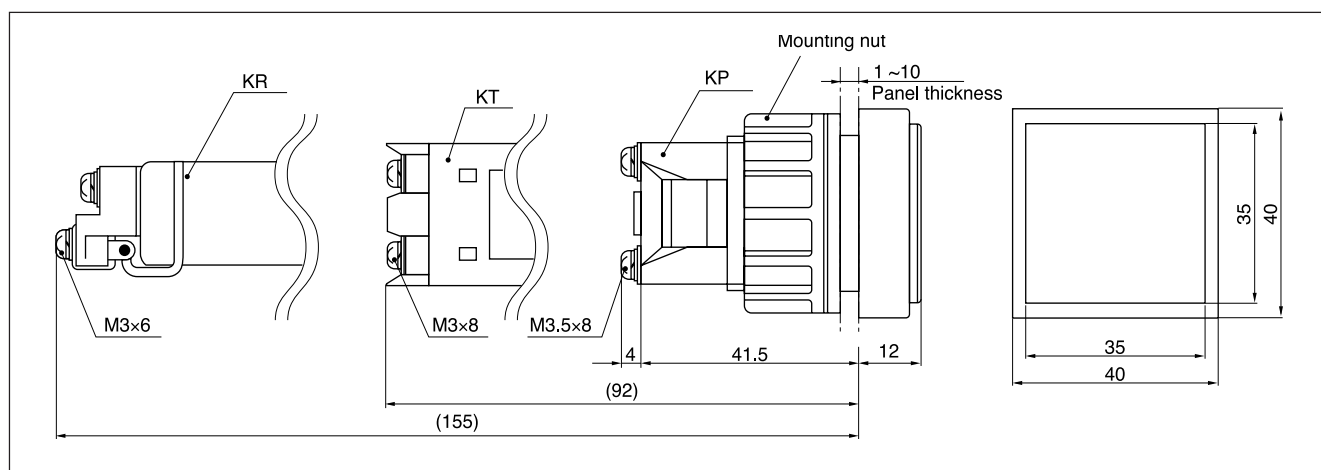

## ■ Panel Cut • Minimum Pitch (unit: mm)

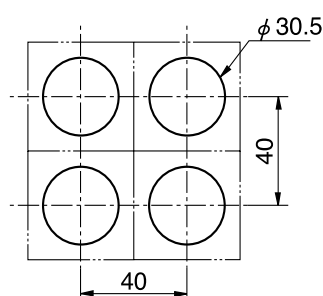

## ■ Legend Plate • Color Filter (unit: mm)

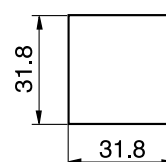

Engraving space : 31.8 × 31.8mm  
 Legend plate thickness : 1mm  
 Filter thickness : 1mm

## ■ Mounting

Remove the mounting nut from the right and insert from the front surface of the panel. From the back, use the KX-2 or KX-3 mounting tool to fasten the nut. Recommended torque is 2.5 ~ 3N·m.

## Tools

### ▼ KX-2 (Mounting tool for KP/KT/KR-337)

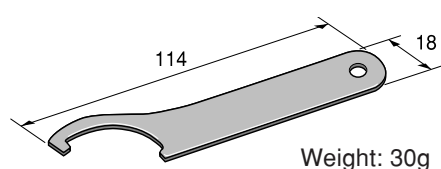

Weight: 30g

### ▼ KX-3 (Mounting tool for KP/KT/KR-337)

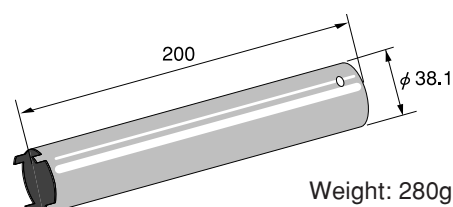

Weight: 280g

### ▼ KX-1 (Removing tool for light cover)

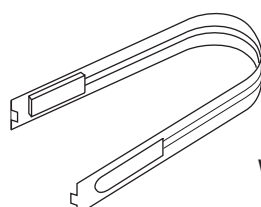

Weight: 8.5g