

Fuse Holder / Fuse Carrier

F / FC Series

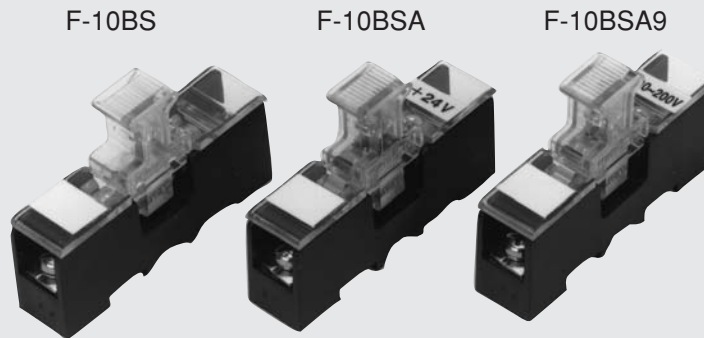

■ Features

- This Fuse Holder is used for circuit protection for instruments, operation boards, control boards, power switchboards, etc.
- Applicable either to DIN rail mounting or simple body mounting.
- The carrier for attaching/detaching fuse tube is separately available.
- The fuse carrier with lamp, available for 24V, 100V and 200V, is used for blown-fuse indication by the lamp.
- Are available 400V.(Model FC-30)

■ Model Designation

■ Fuse holder + Carrier

F - 10BS

F - 10BSA

Circuit voltage for indicator lamp

4 : 24V DC

9 : 100 ~ 200V AC

■ Specifications

Item \ Model	F-10BS	F-10BSA4	F-10BSA9
Rated Insulation Voltage	250V		
Rated Current	10A		
Adaptable Fuse	φ 6.4×30L φ 6.35×31.8L		
Terminal Screws	M4×10 (square washer) Carbon steel (galvanized and chromate treatment) Recommended torque: 1.4~1.8N·m		
Fuse Holder Materials	Polyamide resin (black)		
Carrier Materials	Polycarbonate resin (transparent)		
Legend Tag	Paper (white)		
Disconnection Indication (lighting out when power is ON)	Not available	LED	Neon tube
Circuit Voltage Indication	—	24V DC	24V DC
Insulation Resistance	100MΩ or more between live parts and ground measured by 500V DC megohmmeter		
Withstand Voltage	2000V AC for 1 minute between live parts and ground and between live parts		
Operating Environment	Temperature: -10~50°C Humidity: 45~85%RH (No freezing or condensation)		



NOTICE

- 24V of F-10-BSA4 use LED as a light source. Therefore, there is polarity when used in DC circuit and even when the fuse blowout, 2-3mA is used as the LED flushes. When load resistance is more than 10kΩ, LED may not flush.
- Fuse tube is not attached to the above products.
- Unless otherwise mentioned, all dimensions are indicated in "mm" in this book.

■ Dimensions

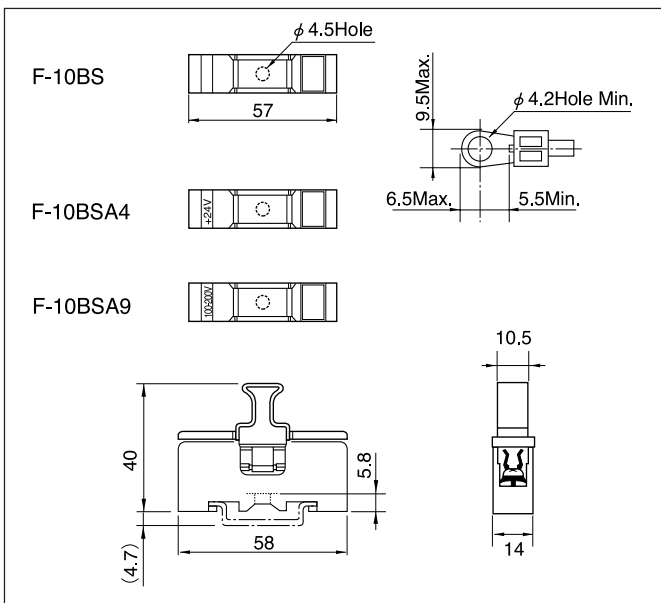

■ Mounting

When mounting F-10BS on the DIN rail, be aware that there are movable and fixed sides for the rail mounts. Hold the F-10BS with the fixed side downwards; hook it on the rail before pushing the movable side on to the rail.

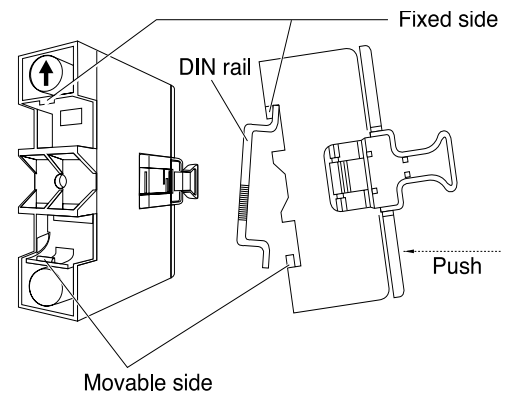

■ Model Designation

■ Fuse holder

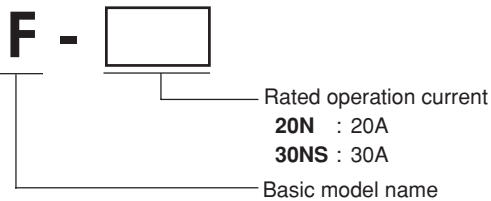

▼ F-20N

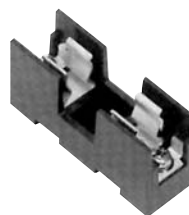

▼ F-30NS

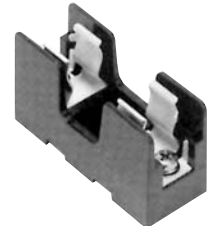

■ Fuse Carrier

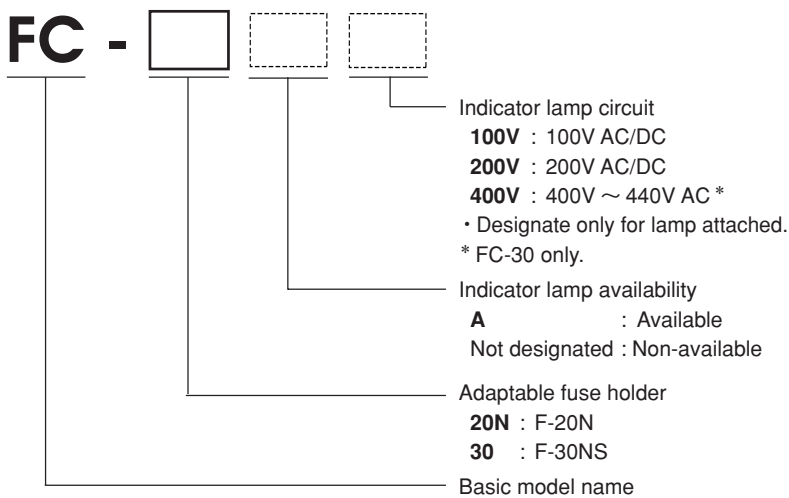

▼ FC-20N/A



▼ FC-30/A



Specifications

Item	Fuse Holder		Fuse Carrier			
	F-20N	F-30NS	FC-20N	FC-20NA	FC-30	FC-30A
Rated Insulation Voltage	250V	660V	—			
Rated Currency	20A	30A	—			
Adaptable Fuse	φ 10×38L	φ 15×50L	φ 10×38L		φ 15×50L*	
Terminal Screws	M4×8 Recommended torque: 1.4~1.8N·m	M5×10 Recommended torque: 2~2.5N·m	—			
Main Body Materials	PBT resin (black)		Polycarbonate resin (smoky gray)		Polycarbonate resin (clear)	
Lamp (when power is ON)	—		Without neon tube	Neon tube	Without neon tube	Neon tube
Insulation Resistance	100MΩ or more between live parts and ground, and between live parts measured by 500V DC megohmmeter					
Withstand Voltage	2000V AC for 1 minute between live parts and ground, and between live parts (2500V AC for 1 minute with F-30NS)					
Operating Environment	Temperature: -10~40°C Humidity: 45~85%RH (No freezing or condensation)					

*JISC8314 Cartridge fuse

Dimensions

Fuse holder

▼ F-20N Weight : 22g

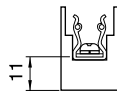
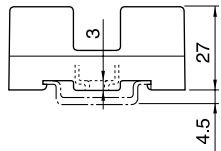
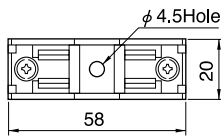

▼ F-30NS Weight : 59g

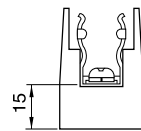
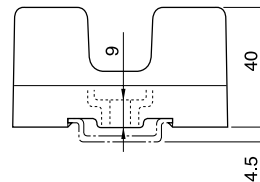
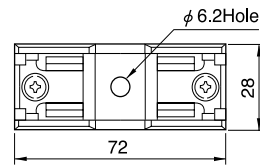

Fuse Carrier

▼ FC-20N (without lamp) Weight : 4.2g
 FC-30 (without lamp) Weight : 10g

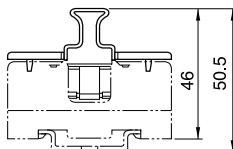
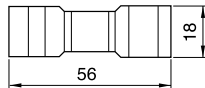

▼ FC-20NA (with lamp) Weight : 5.2g
 FC-30A (with lamp) Weight : 11g

